

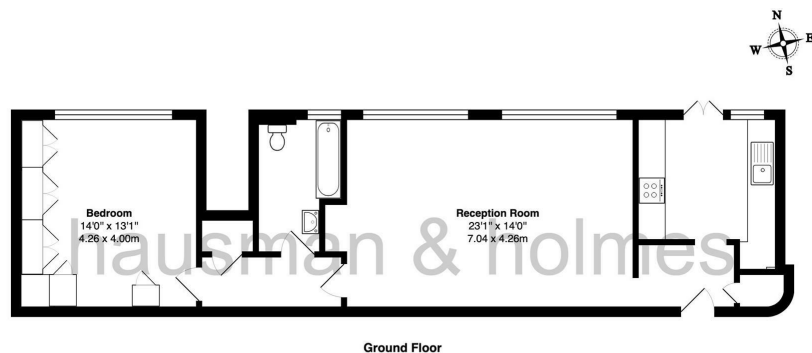

hausman
& holmes

Riverside Drive, Golders Green Road, NW11
Asking Price £400,000



Riverside Drive Golders Green Rd NW11
Total Gross Area: 757 ft² ... 70.3 m²
All measurements are approximate and for identification guideline purposes only, not to scale.
Compliant with the RICS code of measuring practice

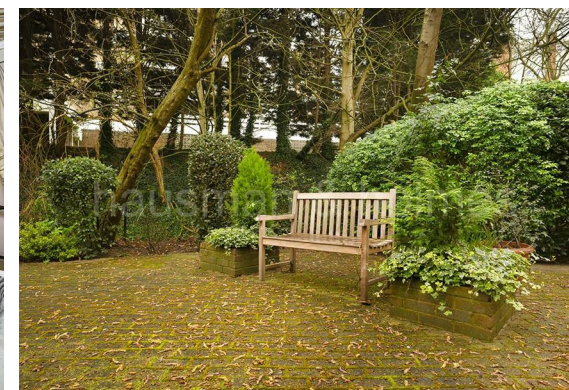

- Exceptionally spacious one bedroom apartment
- Beautiful communal gardens
- 757 sq. ft.
- Unusually large 23 ft. reception room
- Benefits from portage & lifts to all floors
- On-site parking on a first come basis



020 8458 8555
57 Golders Green Road
London NW11
info@hausmanandholmes.com

Energy Efficiency Rating		
Very energy efficient - lower running costs	Current	Potential
A (92 plus)		77
B (81-91)		
C (69-80)		
D (55-68)	62	
E (39-54)		
F (21-38)		
G (1-20)		
Not energy efficient - higher running costs		
England & Wales		
EU Directive 2002/91/EC		

Compliant with RICS code of measuring practice, Particulars and floor plans are only a guide to the property and do not constitute or form part of any offer or contract and are not to be regarded as representation of fact. Any intending purchaser must satisfy themselves as to the accuracy of these particulars as they are given without responsibility. No person in the employment of Hausman and Holmes has any authority to make or give representation or warranty to properties being sold.